



TYPE 44 FULL BORE GATE VALVE

FULL BORE Gate Valves are designed especially for harsh environments encountered while frac, snubbing, or work over operations. FULL BORE Gate Valves uses the industry proven metal sealing, floating slab type gate. Standard API Ring Gaskets are used to seal the Bonnet to the Body. The ease of maintenance and reliability make the FULL BORE valves well suited for all oil and gas operations.

The FULL BORE Gate Valves are compact and lower in weight than competitive gate valves of the same size. But, are rugged and strong enough to withstand the toughest service conditions.

AXON Energy Products offers two types of manually operated valves. The basic manual valve has a non-rising stem and a standard stem to gate thread actuation. This is available in only the 10,000 and 15,000 psi W.P. valves. The Model "LT" (Low-Torque) operator uses a rising stem design and "Ball-Screw" actuation to reduce the operating and opening under pressure torques. A unique feature of the "LT" and Hydraulic operators are that they are completely interchangeable between bodies. The Gate, Seats, and Body are identical. A customer can purchase a Body and the "LT" and Hydraulic operators and be able to convert from manual to hydraulic operation in a very short amount of time.

A unique equalizing manifold block is integrally mounted on the side of the valve body. Two flush mounted needle valves with replaceable seats are provided. The equalizing block is sealed to the body by .50" bore AX metal sealing gaskets. Porting through the Body and Block allows pressure equalization across a closed gate. This option is recommended for the manual valve to lessen the high torque required for opening under high pressure.

FULL BORE Gate Valves meet NACE MR-0175 material requirements. All API Specification 6A PSL levels can be provided.

FULL BORE Gate Valves are furnished with studded API flange end connections as standard. Flanged models are available. Special trims are available per customer request.

TYPE 44 FULL BORE GATE VALVE

7-1/6" API 10000/15000/20000 PSI

DIMENSIONS (INCHES)

	10,000 PSI W.P.	15,000 PSI W.P.	20,000 PSI W.P.
A	18.00	22.00	24.50
B	17.19	18.13	19.50
C	19.25	20.38	26.31
D	28.50	30.38	N/A
E	29.50	31.32	33.50
F	61.22	66.54	69.38
G	44.25	49.88	52.38

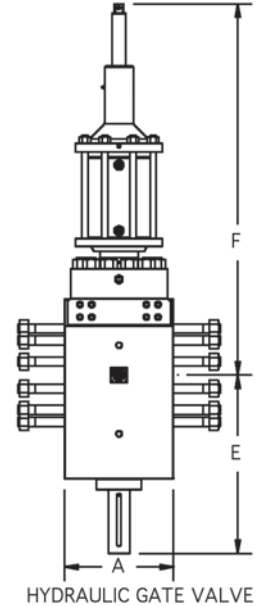
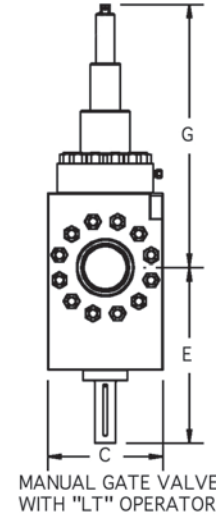
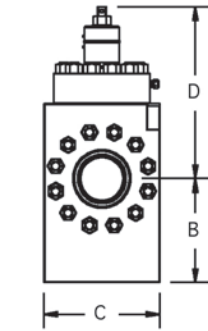

OPERATING PARAMETERS TO OPEN UNDER FULL DIFFERENTIAL PRESSURE ACROSS A CLOSED GATE

	10,000 PSI W.P.	15,000 PSI W.P.	20,000 PSI W.P.
MANUAL	1700 FT-LBS	3100 FT-LBS	N/A
MANUAL W/ LT	130 FT-LBS	200 FT-LBS	180 FT-LBS
HYDRAULIC	1000 PSI	1100 PSI	1100 PSI

MANUAL GATE VALVE HYDRAULIC GATE VALVE WITH "LT" OPERATOR

	10,000 PSI W.P.	15,000 PSI W.P.	20,000 PSI W.P.
MANUAL	3800 LBS.	4300 LBS.	N/A
MANUAL W/ LT	4000 LBS.	4600 LBS.	5100 LBS.
HYDRAULIC	4200 LBS.	4800 LBS.	5300 LBS.